

# KSS Single Inlet Centrifugal Fan (Metal Body)

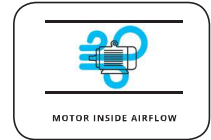

**Description :**

KSS fans with their metal sheet bodies, forward-curved impeller and small size can be used in boilers.

MOTOR INSULATION CLASS	F CLASS
MOTOR PROTECTION CLASS	IP 44
MOTOR EFFICIENCY CLASS	-
MOTOR ENCLOSURETYPE	AC EXTERNAL ROTOR MOTOR
BODY MATERIAL	GALVANIZED SHEET METAL
BODY COATING	ELECTROSTATIC POWDER COATING
IMPELLER TYPE	FORWARD CURVED
IMPELLER MATERIAL	GALVANIZED SHEET METAL
DUTY CYCLE	IEC Duty Cycle-S1
WORKING TEMPERATURE	-20 - +50 °C
DIRECTIVE	IEC-60335-2-80, ISO 1940-1



## TECHNICAL SPECIFICATIONS

MODEL	VOLTAGE (V)	FREQUENCY (Hz)	POWER (W)	REV. (RPM)	FLOW RATE (m3/h)	SOUND PRESSURE dB(A) 3m	WEIGHT (KG)
KSS 120 - 60	230	50	84	2.450	275	55	2.7
KSS 140 - 60	230	50	137	2.265	485	58	3.4
KSS 160 - 60	230	50	193	2.100	600	61	4.5

Values are for 0 Pa

## TECHNICAL DRAWING

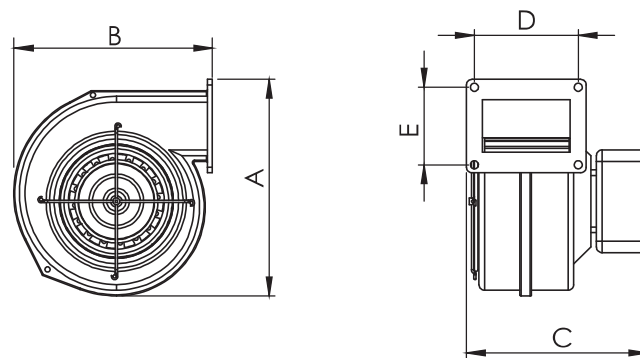

MODEL	A (mm)	B (mm)	C (mm)	D (mm)	E (mm)
KSS 120 - 60	183	173	134	98.5	68.5
KSS 140 - 60	216	206	133	112	112
KSS 160 - 60	260	270	133	112	112

# KSS Performance Curves

**KSS 120 - 60**

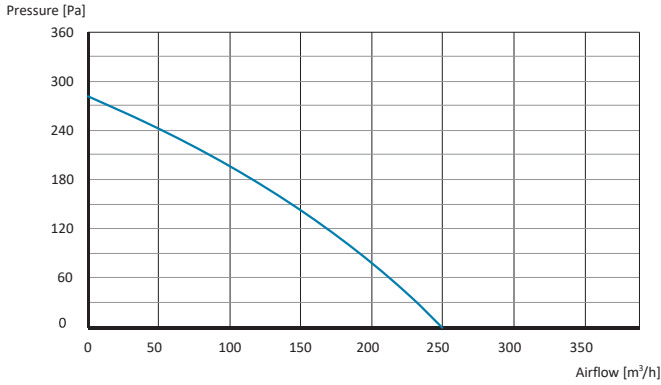

**KSS 140 - 60**

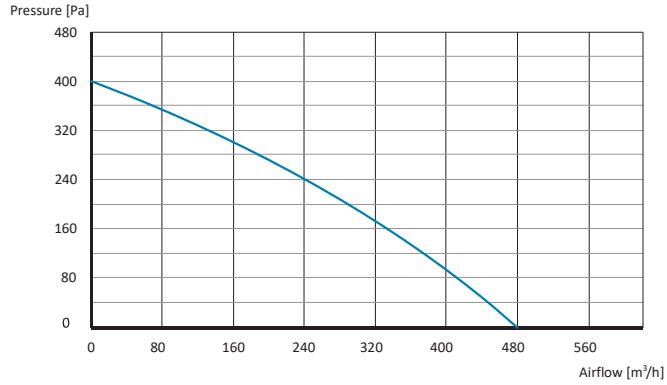

**KSS 160 - 60**

